

12 May 2017

Hill Top
Kite Hill
Wanborough
Swindon
SN4 0DD

Mr Michael J Enright
Rights of Way Officer (Mapping)
Swindon Borough Council
4th Floor, Wat Tyler House West
Beckhampton Street
Swindon
SN1 2JH

Dear Sir

Re: Right of Way between Burycroft and The Marsh, Wanborough

My name is Robert Fisher. I have been a resident of Wanborough for 66 years and I am the stepson of Mr Gerald Anthony Sadler. I can confirm Gerald had owned since the 1970's, until sales in 2008 and 2014, the properties known as Ducksbridge and Honeyfield Farm.

On the section of the Ducksbridge property that Gerald sold for development to Bower Mapson in 2014, Gerald had operated a touring caravan site in conjunction with his pub business in the village, known as the Brewers. Accordingly, I can confirm he actively encouraged the use of access along the path line shown by a red dash line on the attached plan numbered 17885-500-008. Because it made the site more attractive as it enabled people to cut off the corner at the same time as providing a safer route by avoiding the blind bend where Burycroft meets The Marsh, so it was always kept available.

In 2008 when Gerald sold the land now known as Honeyfield Farm, he specifically reserved a right of access up the first part of the track between points X to the gate in the Ducksbridge boundary shown at point W on plan no 17885-500-008, to enable this by then long established pedestrian route, to be retained. My understanding from what my stepfather told me was that the new owners in 2008 bought the land in full knowledge of this.

Finally, I am pleased to confirm my support for this path, as shown by the red dash line on plan no 17885-500-008, to be registered as a public footpath route.

Yours faithfully

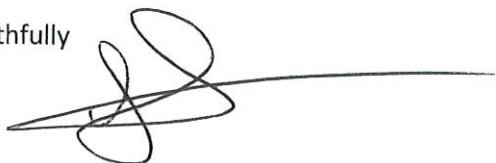
A handwritten signature in black ink, consisting of a series of loops and a long horizontal stroke extending to the right.

Mr Robert Fisher

Enc

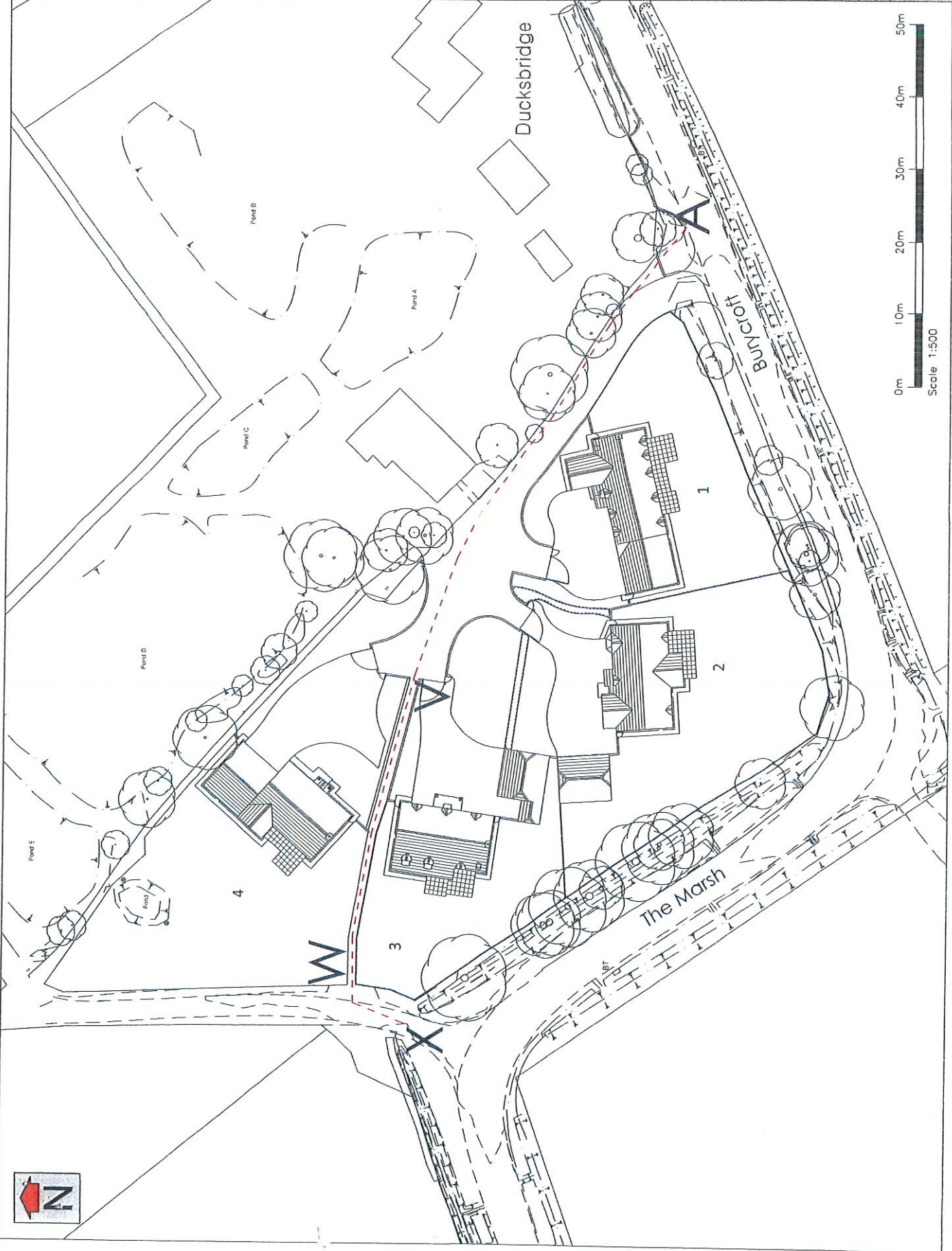

A-V-W-X Indicates route of established permissive path
Shown Thus - - - - -

Between:
Point A: E 420444 N 183488
on Burycroft highway verge
To
Point X: E 420333 N 183726
on the Marsh highway verge

Brunel Surveys Ltd
UNIT 21, SHREVEHAM IMPROVED BUSINESS PARK
WINDYBUSH, WINDYBUSH, WINDYBUSH, WINDYBUSH
TEL: 01793 24700 FAX: 01793 24744
WEB: www.brunelsurveys.com
enquiries@brunelsurveys.com



Unit 21, Shreveham Impoved Business Park
Windybush, Windybush, Windybush, Windybush
WINDYBUSH, WINDYBUSH, WINDYBUSH, WINDYBUSH

JOB TITLE	Route of Established Permissive Path A-V-W-X
REVISIONS	
SCALE	A3 Sheet @ 1 to 500
DATE	4 MAY 2017
DRAWN BY	PAH
CHECKED BY	PAH
DRAWING No.	17885-500-008