

100  
Millimetres  
0 10  
DO NOT SCALE

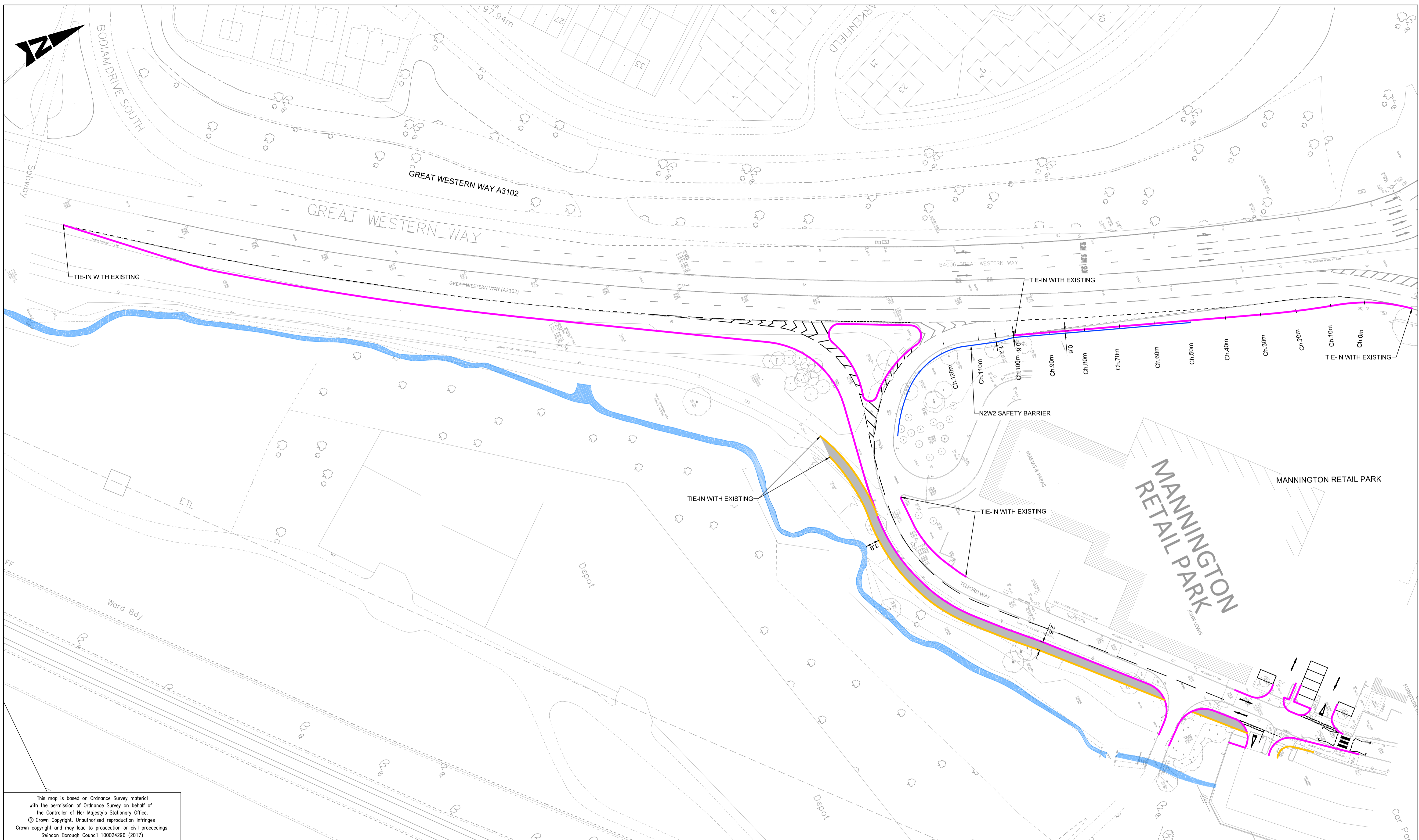

This map is based on Ordnance Survey material with the permission of Ordnance Survey on behalf of the Controller of Her Majesty's Stationary Office.  
© Crown Copyright. Unauthorised reproduction infringes Crown copyright and may lead to prosecution or civil proceedings.  
Swindon Borough Council 100024296 (2017)

SAFETY, HEALTH AND ENVIRONMENTAL INFORMATION	
In addition to the hazards/risks normally associated with the types of work detailed on this drawing, note the following significant residual risks (Reference shall also be made to the design hazard log).	
Construction	None
Maintenance / Cleaning	None
Use	None
Decommissioning / Demolition	None

NOTES	
1.	DO NOT SCALE FROM THIS DRAWING.
2.	ALL DIMENSIONS ARE IN METRES UNLESS OTHERWISE STATED.
3.	THIS SKETCH IS INTENDED AS A PRELIMINARY OPTION DESIGN AND NOT IS FOR CONSTRUCTION PURPOSES.
4.	EXISTING AND PROPOSED MARKINGS ARE SHOWN INDICATIVELY.

KEY	
	PROPOSED CARRIAGEWAY EDGE
	PROPOSED EDGING
	N2W2 SAFETY BARRIER
	PROPOSED CYCLEWAY / FOOTWAY
	EXISTING STREAM

P01.1	RA/HC	OMI	30.10.2017
DRAFT ISSUE			
Rev	Drawn / Des	Checked	Approved
Description			

Drawing Status: **WORK IN PROGRESS**      Suitability: **SO**

**ATKINS**      County Gate, County Way  
Trowbridge, Wiltshire England  
BA14 7FJ  
United Kingdom

Copyright © Atkins Limited (2017)      Tel: +44 (0)1225 730360  
Fax: +44 (0)      www.atkinsglobal.com

Client: **SWINDON BOROUGH COUNCIL**

Project Title: <b>Mannington Roundabout Quality Bus Corridor Highway Improvements</b>				
Drawing Title: <b>LAYOUT PLAN (OPTION - 4) (SLIP ROAD JUNCTION)</b>				
Scale: 1:500	Designed / Drawn: HC/RA	Checked: OMI	Approved:	Authorised:
Original Size: A1	Date: 30.10.2017	Date: 30.10.2017	Date:	Date:
Drawing Number: 5160658-ATK-HGN-0100-DR-D-1011	Project:	Originator:	Volume:	Job No. 5160658
Location:	Type:	Role:	Number:	Revision: P01.1

Plotted: Oct 31, 2017 - 2:35pm by: ALIS6816