

**PROTECTION AGAINST PRESUMED RIGHTS OF WAY
DEDICATION
Section 31(6) HIGHWAYS ACT 1980 deposit**

We, **R J CODRINGTON & N C CODRINGTON** of Wroughton House, Wroughton, Swindon in the County of Wiltshire declare

THAT we are the freehold owners of all the land edged red on the attached plan.

THAT we recognise as public rights of way running over the land only those routes coloured green on the attached plan; and

THAT we have no intention to dedicate any further ways to public use and wish this deposit to be lodged with the appropriate Council under Section 31(6) of the Highways Act 1980 as evidence that no intention of dedication should be presumed.

Signed : *Signature not displayed*
R J CODRINGTON

Signed : *Signature not displayed*
N C CODRINGTON

On the *11th* day of *Nov* 2003

REPLY: *Y/N* REF: *33968*
CAT: CLLR ACK: *Y/N*
ASS TO: PASSED TO:
Annie

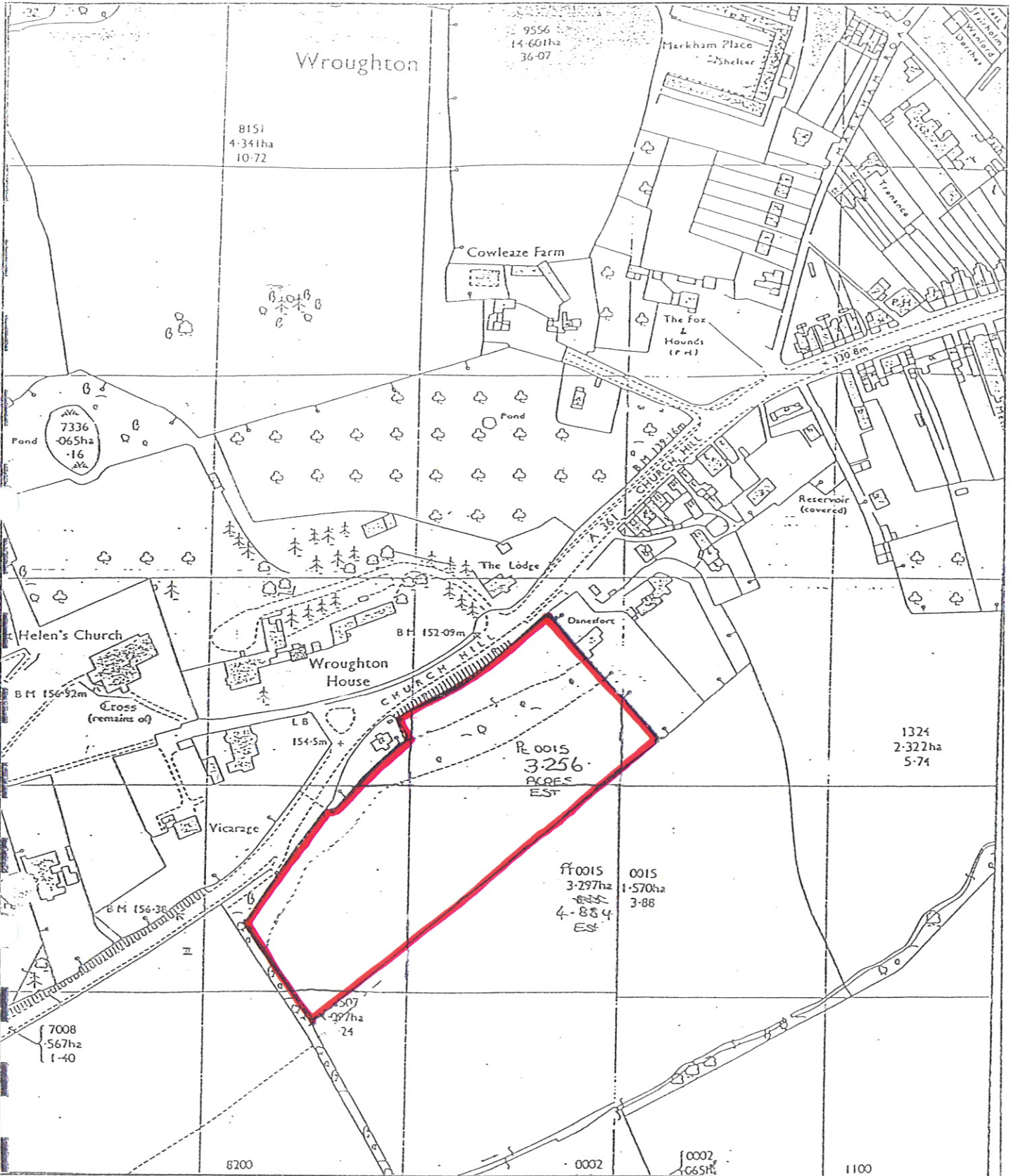

LAND AT CHURCH HILL, WROUGHTON

DREWEATT · NEATE

CHARTERED SURVEYORS · ESTABLISHED 1759

Vectis Court Newport Street Swindon Wiltshire SN1 3DX
Facsimile 01793 511291 Telephone 01793 611129

SCALE *1:2500*

O. S. No

PLAN No *1B/SWA1407*

DATE *OCTOBER 2003*

Reproduced from the 19..... Ordnance Survey 1:..... scale map with the permission of
The Controller of Her Majesty's Stationery Office. © Crown Copyright ES762571
Dreweatt Neate, Chartered Surveyors, Donnington Priory, Oxford Road, Donnington, Newbury RG13 2JE.