

WA 05

STATUTORY DECLARATION

HIGHWAYS ACT 1980 SECTION 31 (6)

I LOUISE SMITH DO SOLEMNLY AND SINCERELY DECLARE as follows:

1. The Woodland Trust, a company limited by guarantee and registered charity no. 294344, is and has been since 30<sup>th</sup> December 1993 the owner of the land known as Warneage Wood, Wanborough, Swindon more particularly delineated on the plan accompanying this declaration and thereon edged red.
2. On the 29th of January 1996 the Woodland Trust deposited with Swindon Borough Council, being the appropriate Council, a statement accompanied by a plan delineating our property by red edging which stated that the ways coloured purple on the said plan and on the plan accompanying this declaration had been dedicated as footpaths no other ways had been dedicated as highways over our property.
3. No additional ways have been dedicated over the land edged red on the plan accompanying this declaration since the statement dated 29<sup>th</sup> February 1996 referred to in 2 above other than those highways with footpaths marked in the appropriate colour on the plan accompanying this declaration and at the present time the Woodland Trust has no intention of dedicating any more public rights of way over its property.

AND I MAKE this solemn declaration on the 13th day of November 2001 conscientiously believing it to be true and by virtue of the Statutory Declarations Act 1835.

Declared at: Mills & Reeve, Francis House, 112 Hills Road, Cambridge, CB2 1PH

*Signature not displayed*

Louise Smith

Assistant Land Agent authorised to sign on behalf of the Woodland Trust

Before me, Michael Aubrey, Solicitor

*Signature not displayed*

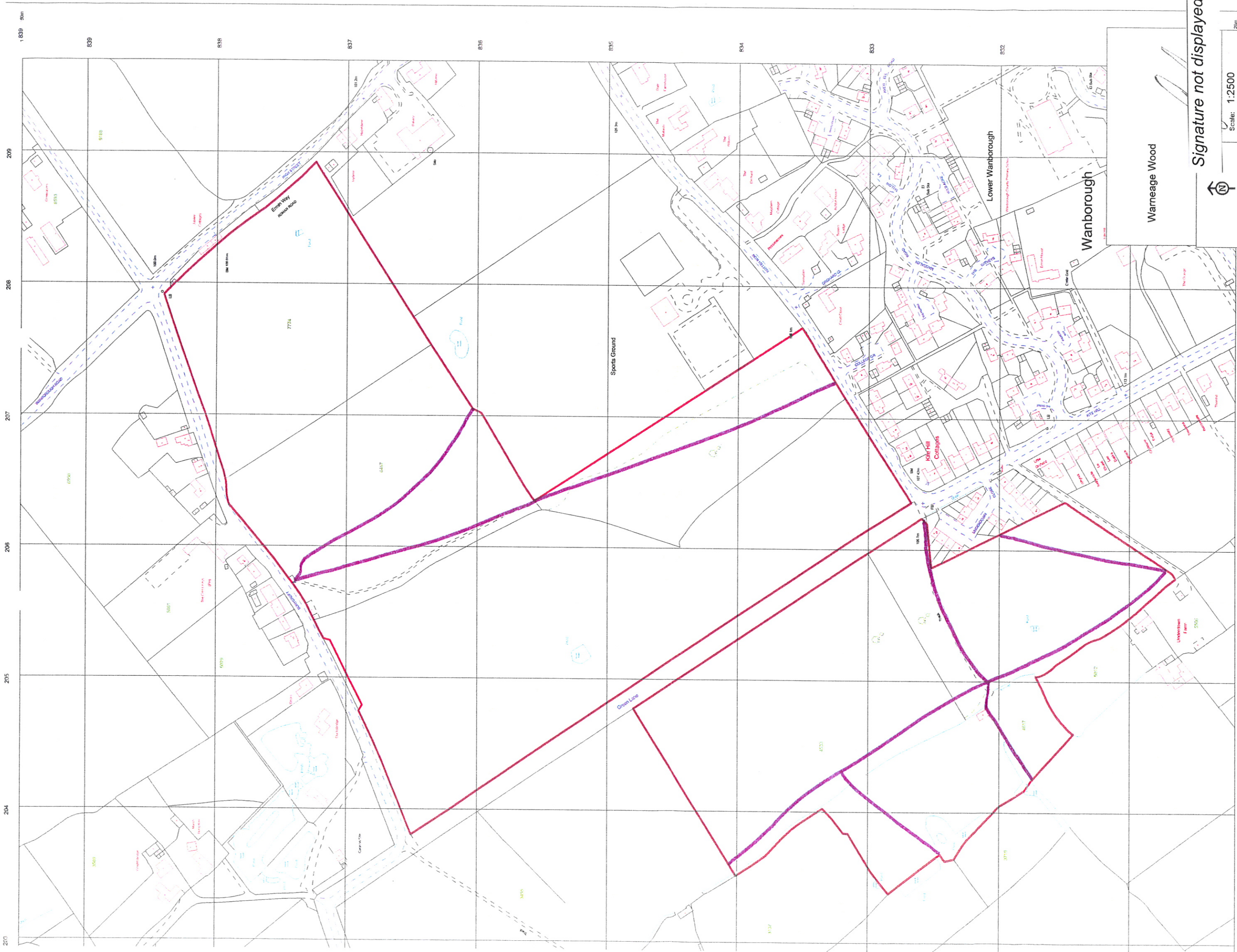

Warneage Wood

Signature not displayed



WOODLAND TRUST

|                                 |              |
|---------------------------------|--------------|
| Scale:                          | 1:2500       |
| Author:                         | LS           |
| Date:                           | 26/06/10     |
| Reproduced from Ordnance Survey | digital data |
| © Crown Copyright               | AL559385     |

Plan referred to in the statutory  
Declaration by house party

Signature not displayed

13th November 2001