

Church Commissioners for England

**Deposit of statement and plan pursuant to section 31(6) Highways Act 1980 with
Swindon Borough Council**

1. I, **VIVIEN BROOKS**, am the Assistant Rural Assets Manager of the Church Commissioners for England ("the Commissioners"). The Commissioners are the owners within the meaning of the above section of the land known as Bishopstone Estate more particularly delineated and shown edged red on the plan accompanying this statement.

2. On behalf of the Commissioners I admit that the ways coloured green-dashed on the plan have been dedicated as public footpaths, the ways coloured green-crossed have been dedicated as bridleways and the ways coloured green-double crossed have been dedicated as byways open to all traffic.

Signed by Signature not displayed

Name .. V. BROOKS

Address .. CHURCH COMMISSIONERS FOR ENGLAND
CHURCH HOUSE

.. GREAT SMITH ST, ROWDON SW1P 3AZ
Date .. 11/3/13

Signed by Signature not displayed (Witness)

Name .. R. CHODGERS

Address .. CHURCH COMMISSIONERS
CHURCH HOUSE, GR. SMITH ST
LONDON SW1P 3AZ

Occupation .. Rural Asset Manager

Date .. 11/3/2013

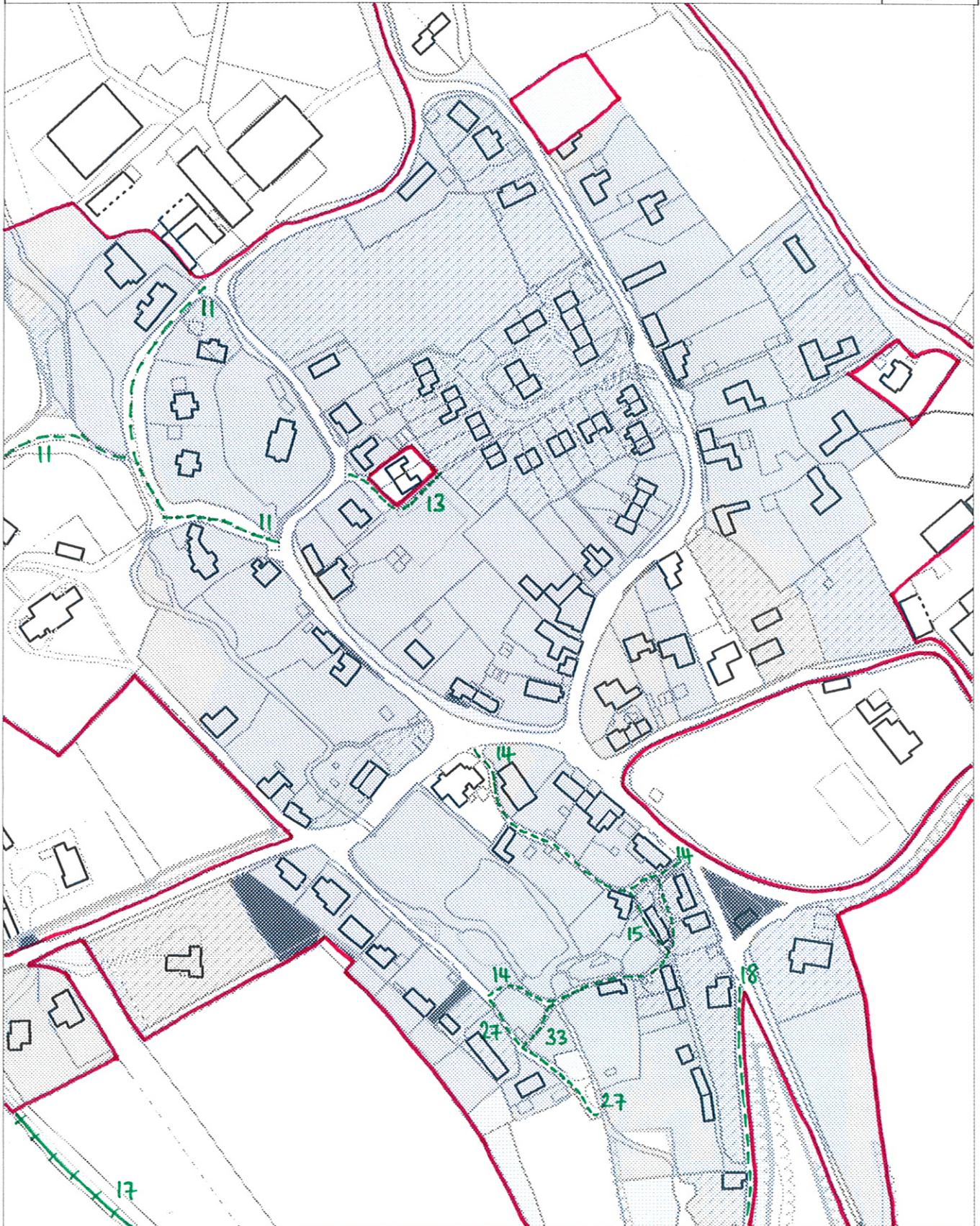
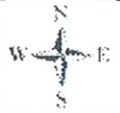

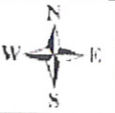

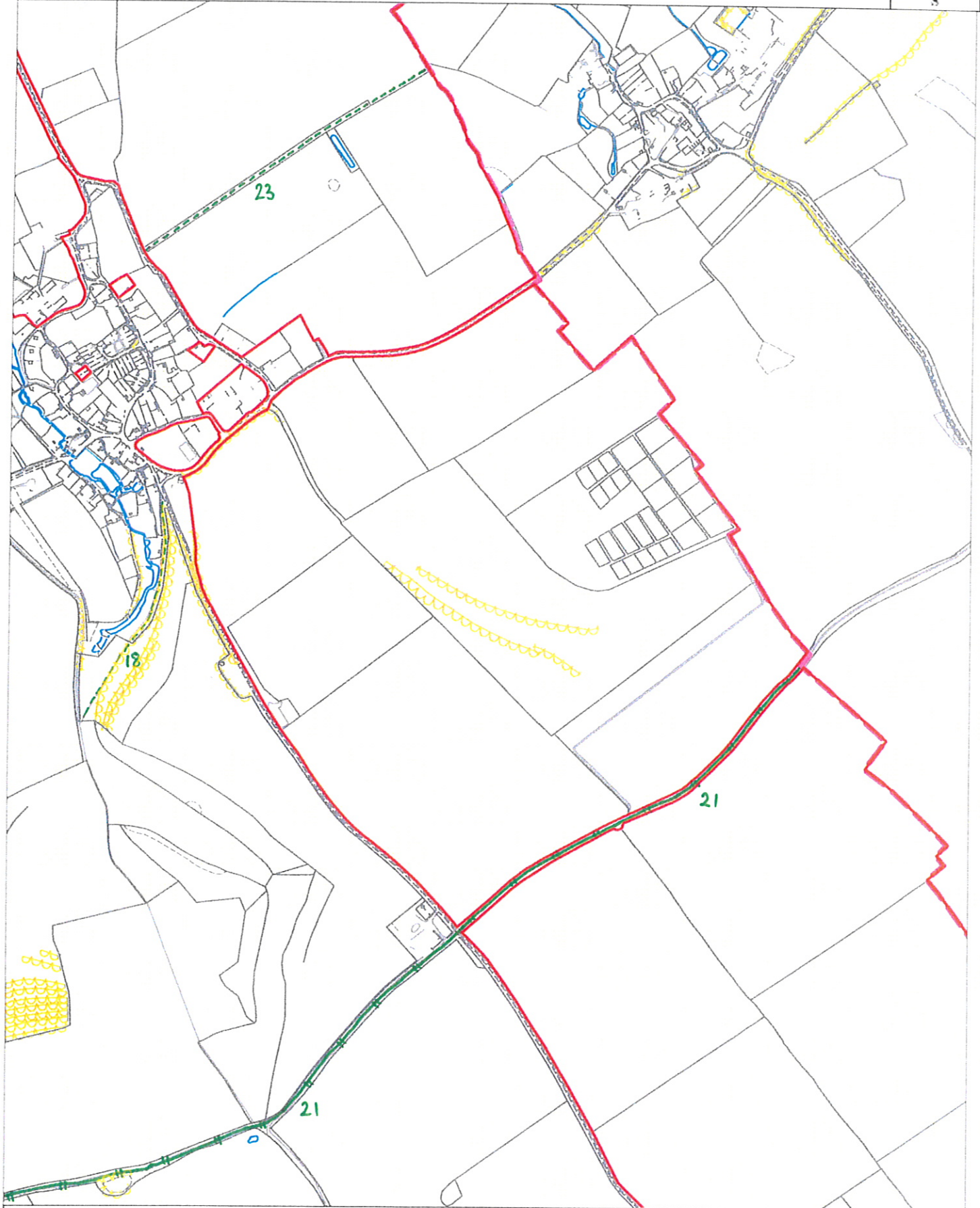
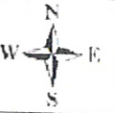

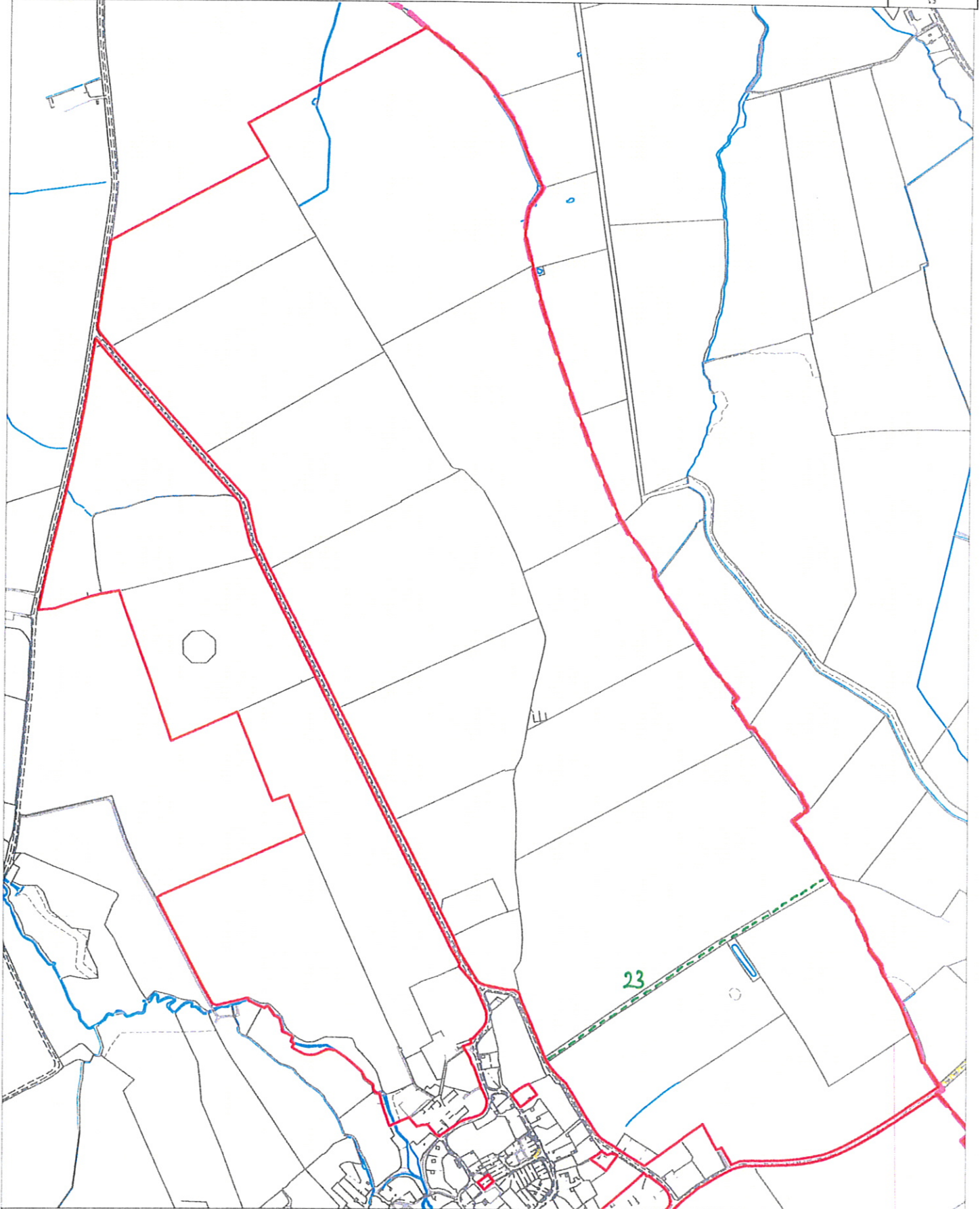
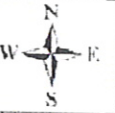

Date : 03 August 2011

Printed By : Louise Spain (Strutt and Parker)

Map Scale : 1:10000

Estate : Bishopstone

Property : Prebendal Farm

Plan Number : 1

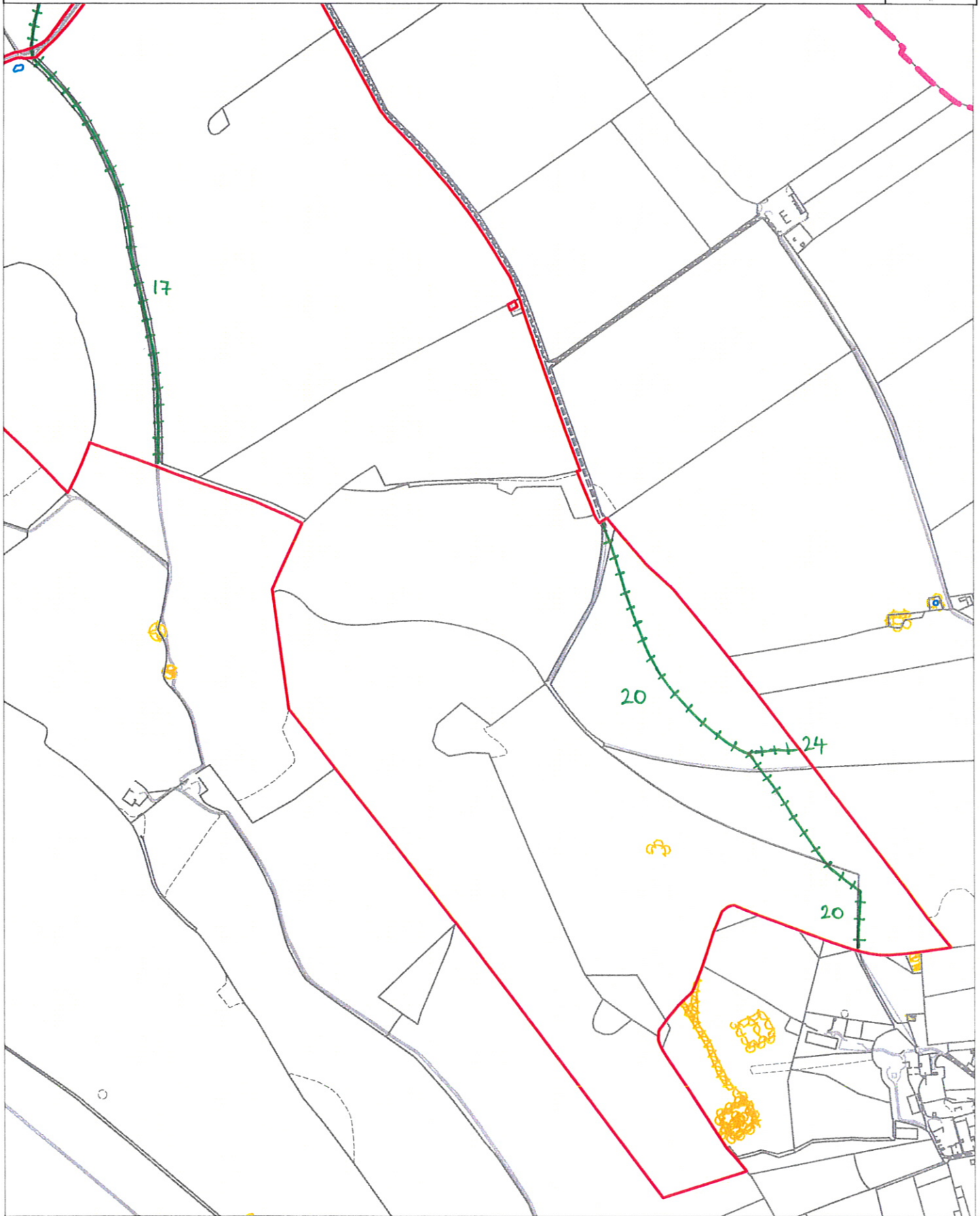

© Crown copyright and Database right 2011. Ordnance Survey Licence number 100040148. Digital Terrain/Surface Model & Aerial Photography © GeoPerSpectives



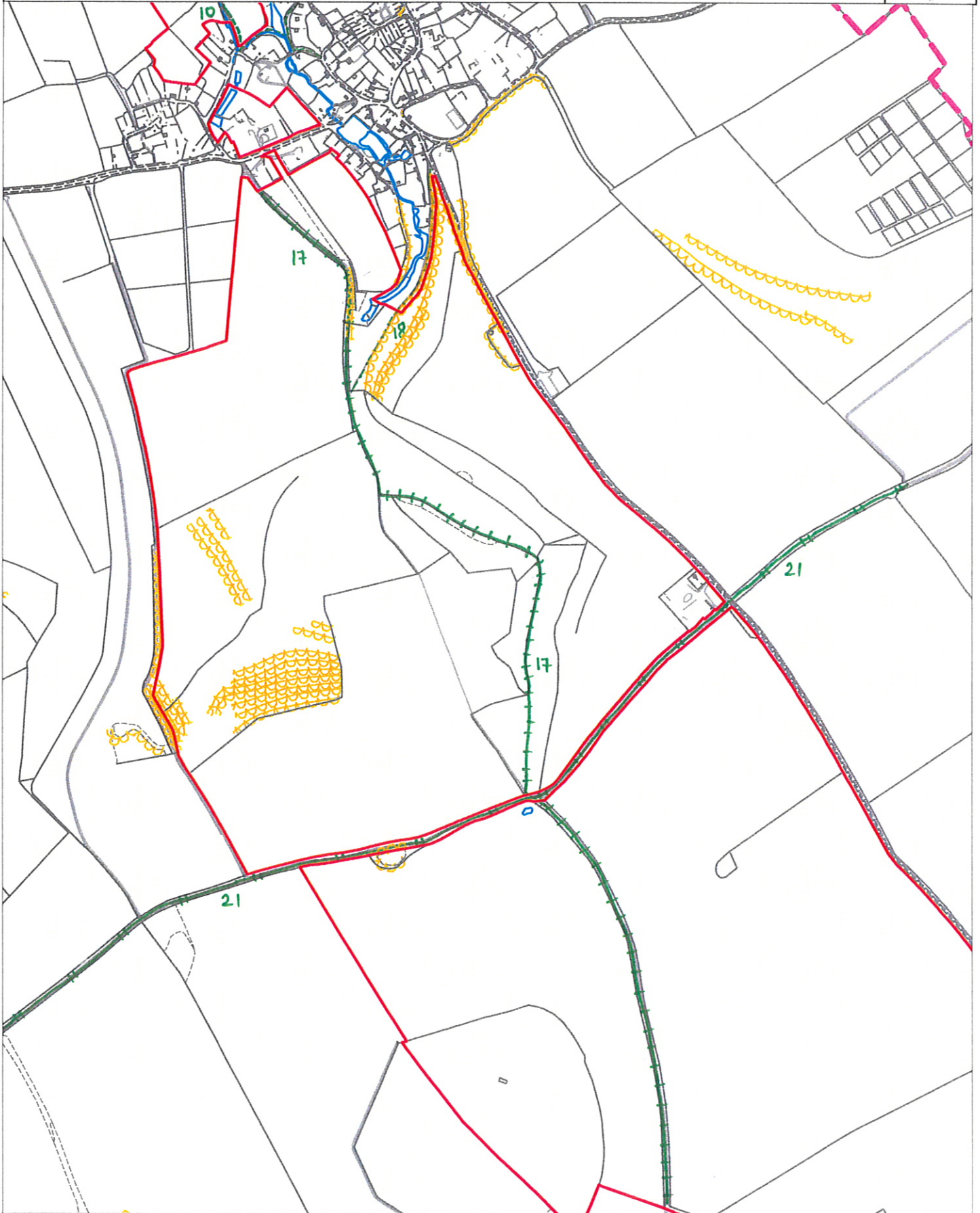

Date : 03 August 2011

Printed By : Louise Spain (Strutt and Parker)

Map Scale : 1:10000

Estate : Bishopstone

Property : Prebendal Farm

Plan Number : 3

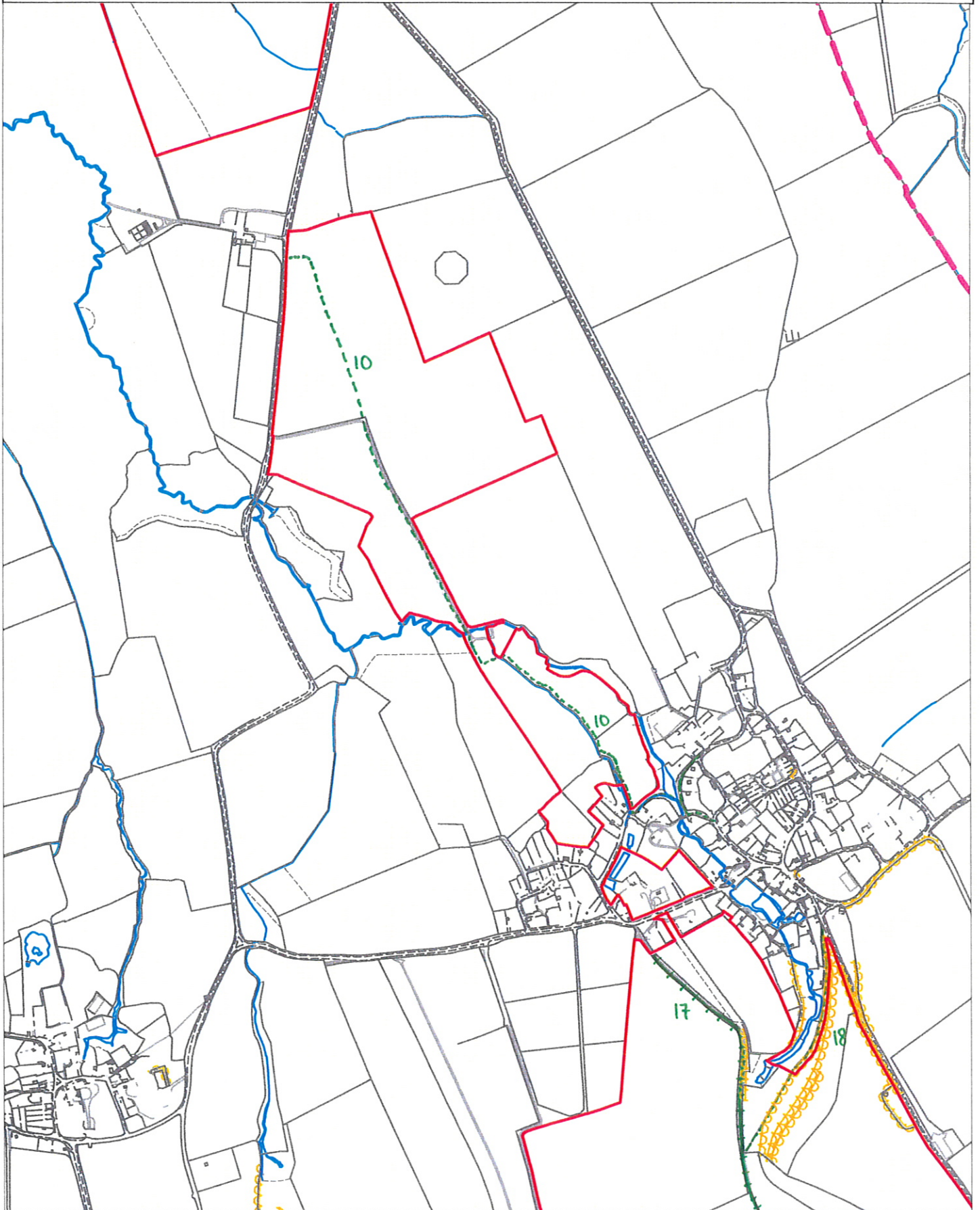

© Crown copyright and Database right 2011. Ordnance Survey Licence number 100040148. Digital Terrain/Surface Model & Aerial Photography © GeoPerSpectives



Date : 03 August 2011
Map Scale : 1:10000
Property : Prebendal Farm
Plan Number : 4

Printed By : Louise Spain (Strutt and Parker)
Estate : Bishopstone

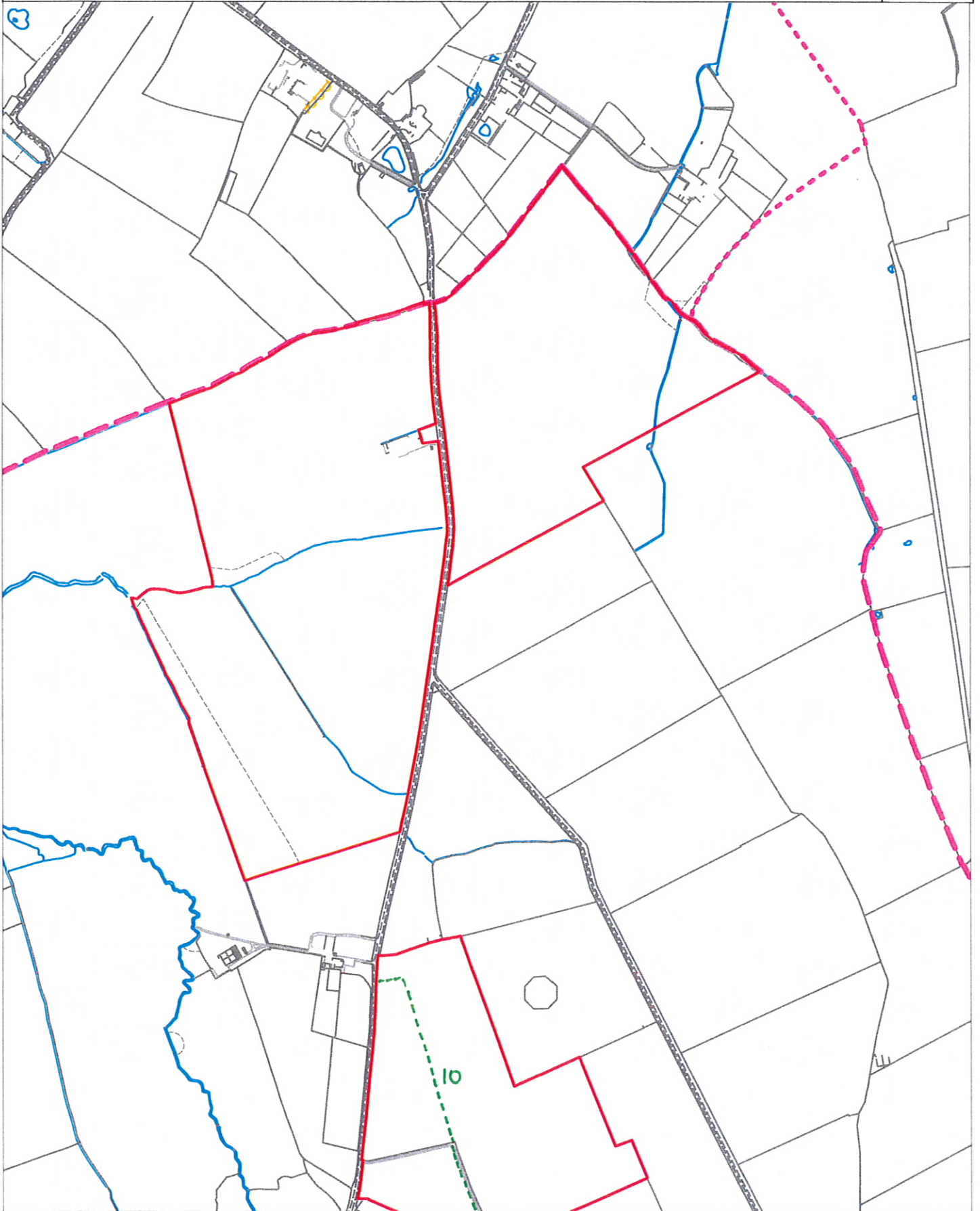
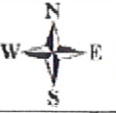

© Crown copyright and Database right 2011. Ordnance Survey Licence number 100040148. Digital Terrain/Surface Model & Aerial Photography © GeoPerSpectives

